

SALES DRAWING SALES DRAWING SALES DRAWING SALES DRAWING SALES DRAWING

SALES DRAWING SALES DRAWING SALES DRAWING SALES DRAWING SALES DRAWING

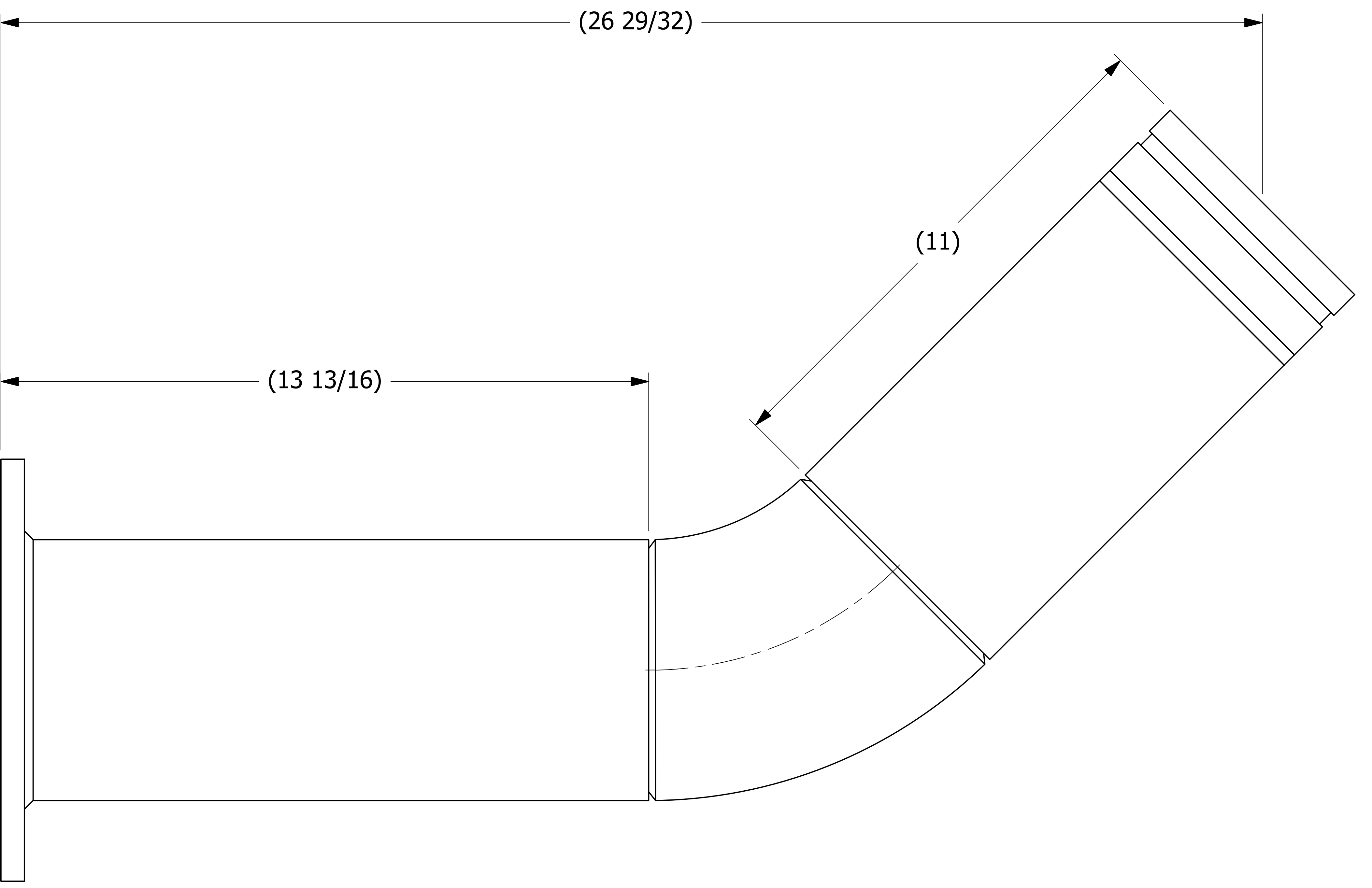
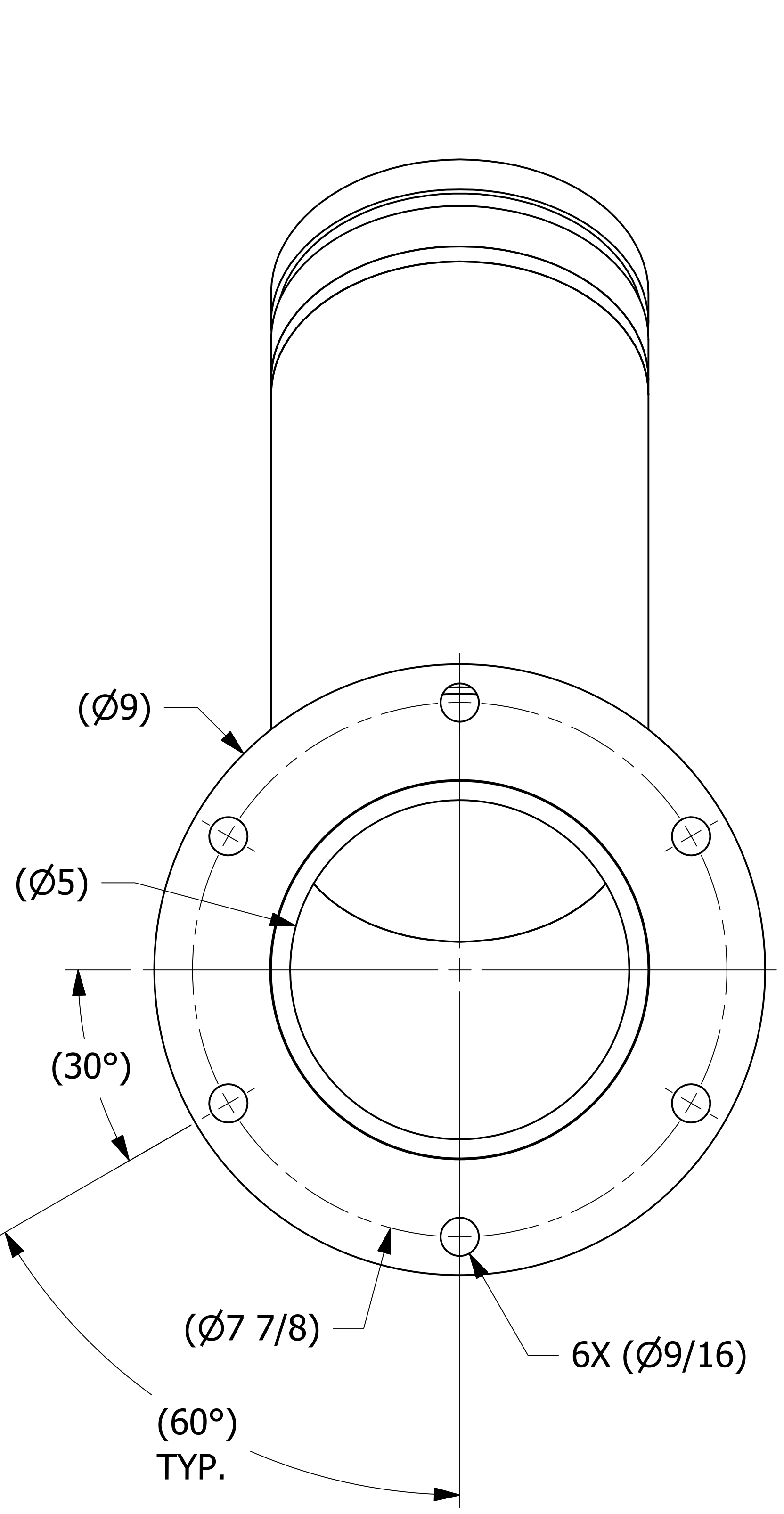

- NOTES:  
 1. PIPES ARE TO BE CUT TO LENGTH.  
 2. WELD IN FIELD AFTER PIPES ARE CUT TO LENGTH.

UNLESS OTHERWISE SPECIFIED DIMENSIONAL TOLERANCES FRACTIONAL: $\pm 1/16$ X.XX: $\pm .03$ X.XXX: $\pm .015$ ANGULAR: $\pm 1^\circ$ DEBURR ALL SHARP EDGES. ALL MACHINED SURFACES TO HAVE A 125 RMS FINISH UNLESS NOTED OTHERWISE. THIRD ANGLE PROJECTION	DRAWN BY:	ACC
	CHECKED BY:	
	PROTOTYPE DATE:	12/14/2001
	APPROVED FOR PRODUCTION BY:	ACC
	PRODUCTION DATE:	12/14/2001
	SIZE:	D
	DRAWING #:	16555

C	WEB	7/2/20	202007021546	WEB
REV	BY	DATE	REF #	PUB
<b>SALCO PRODUCTS, INC.</b>				
PART NAME: PD PIPE ASSEMBLY 5"X45°				
MATERIAL: ALUMINUM				
PROJECT #: 010910			SHEET #: 1 OF 1	SCALE: 3:4
PART #: PD5APB02				